

INTELLIGENT LOCK OPERATION INSTRUCTIONS

CATALOGUE

| | |
|---|----|
| 1. Product parameters | 03 |
| 2. Product size | 03 |
| 3. Indicator / Buzzer Prompt Instructions | 04 |
| 4. Adaptor lock body | 04 |
| 5. The APP process | 05 |
| 6. Restore factory settings and unbind | 14 |
| 7. Installation steps | 15 |
| 8. Basic Annex | 17 |

| Product parameters |
|--|
| Operating voltage : 6V (4 batteries) |
| Operating temperature : -20°C-60°C |
| Fingerprint capacity : 3 administrators 47 regular users |
| Fingerprint module : Semiconductor |
| Working current : 180mA |
| Working humidity : 10%-90%RH |
| Static power consumption : 30uA |
| Open the door : Fingerprints and keys |

Product size

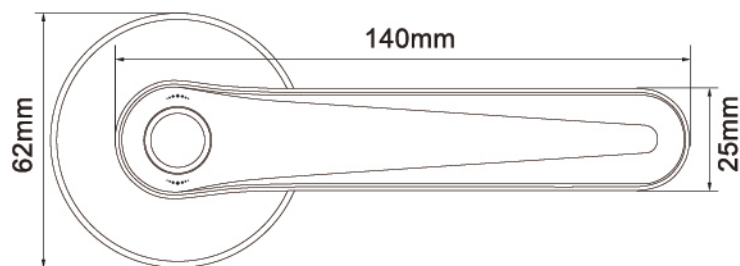

| Indicator / Buzzer Prompt Instructions | |
|---|---|
| Verification success | The indicator light is always bright blue, the buzzer is a long sound |
| Verification failure | Red light flashing, buzzer 3 short sound |
| Match Success | Blue indicator light is always on, buzzer chimes |
| Match failure | Red light flash 3, buzzer 3 short sound |
| Enter the registration status | The pink light is always on |
| Enter the administrator fingerprint verification status | Pink light shining |
| Verify Success Status | Blue LED Light Long |
| Verify Failed Status | Red Light Flashing |
| Reset successfully | Green light on |

Adaptor lock body

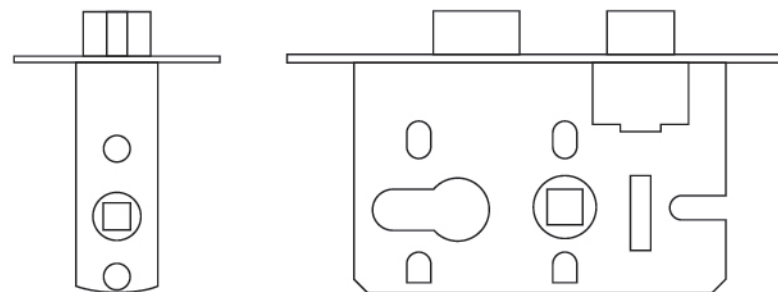

Single tongue standard lock body

Double tongue standard lock body (5845 lock body)

APP Download and Installation

Search for "tuyazhineng" in the APP Market. This document takes smart life APP as an example to explain in detail the APP & door lock panel function.

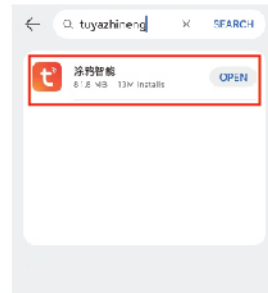

APP Registration, Login

APP Registration:

You don't have an APP account yet, choose log in or log in via SMS verification code.

Click "Create New Account" to enter the account registration page. Follow the prompts to get the SMS verification code and set the password. If you already have an account, you can click "Log in with an existing account" to log in to the app. Login mode supports password, verification code, social account login.

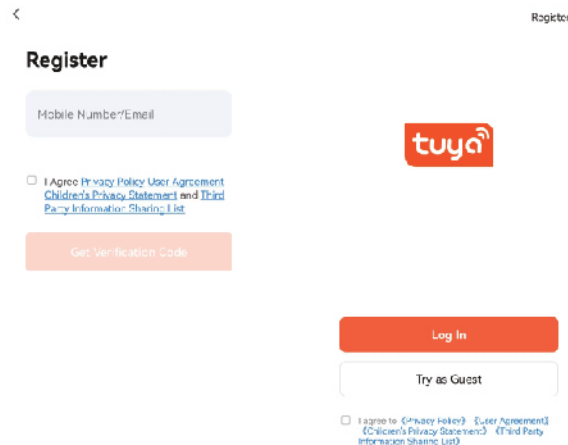

Add Device

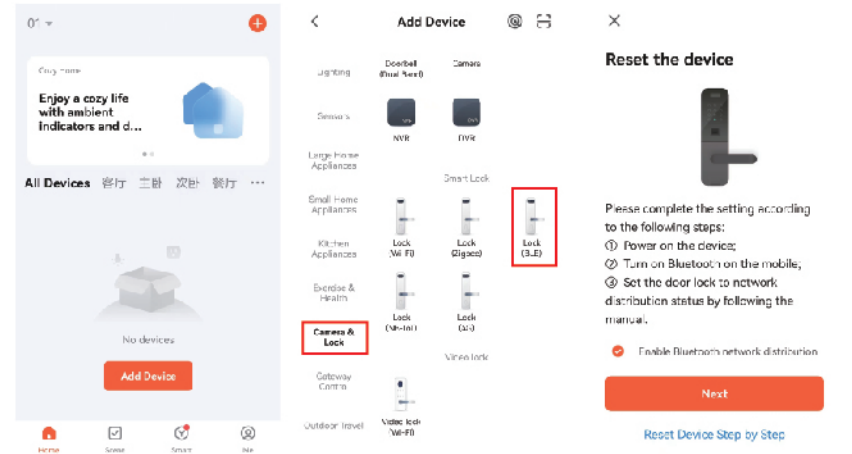

Click Add Device

Find the Camera & Lock
Select Lock (BLE)

Select Start Bluetooth
Click Next

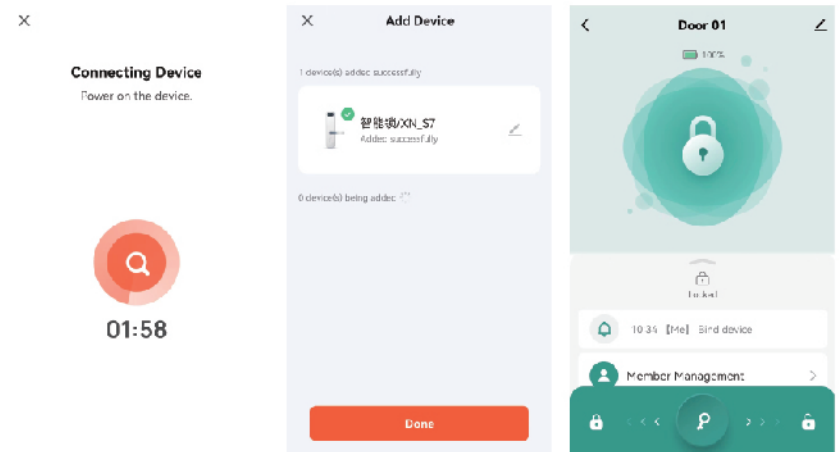

Touch Fingerprint
Wake Up System
Waiting Link Device

Link Success
Click to Done

Enter the door lock
main interface

Bluetooth Door Lock Panel - Home

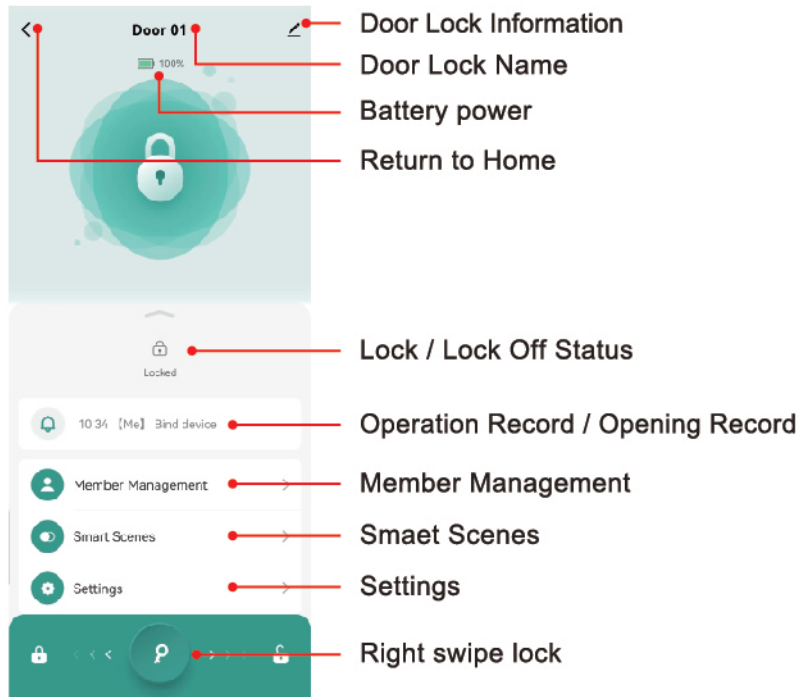

The Home Center displays the Bluetooth connection

Make sure that Bluetooth is turned on and that the phone is operated within 5 meters of the door lock. If Bluetooth is not connected, it shows "Can not connect Bluetooth," can not be unlocked directly through the APP.

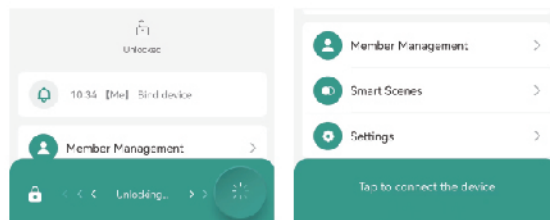

Member Management - Improving Family Members

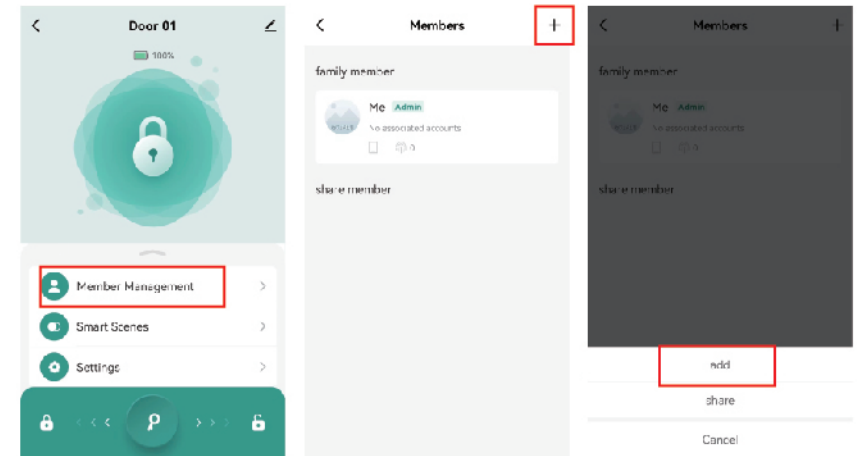

Click Member Management

Click "+" on the top right

Select add

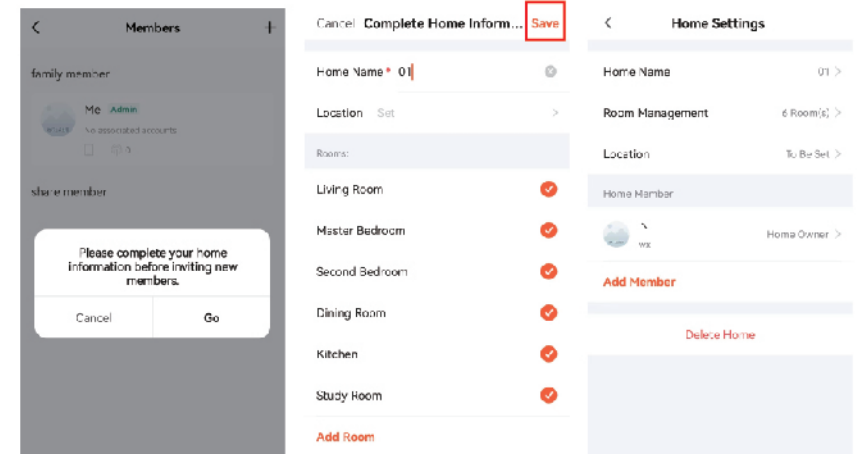

Click Go

Improving Family Information Click Save

You can rename / view / add / remove when finished

Member Management - Set Administrator Fingerprint

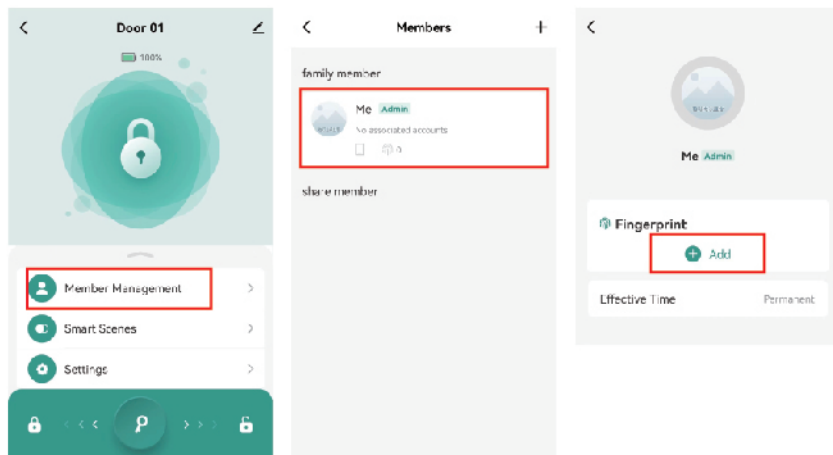

Click Member Management

Click Me Admin

Click + Add

Member Management - Set Fingerprint Permissions

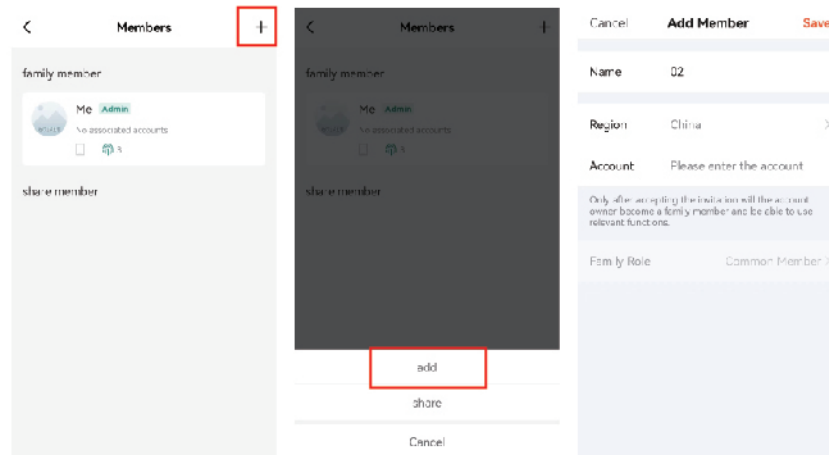

In the Member Admin Panel Click "+"

Click add

Set Member Name
Click to save

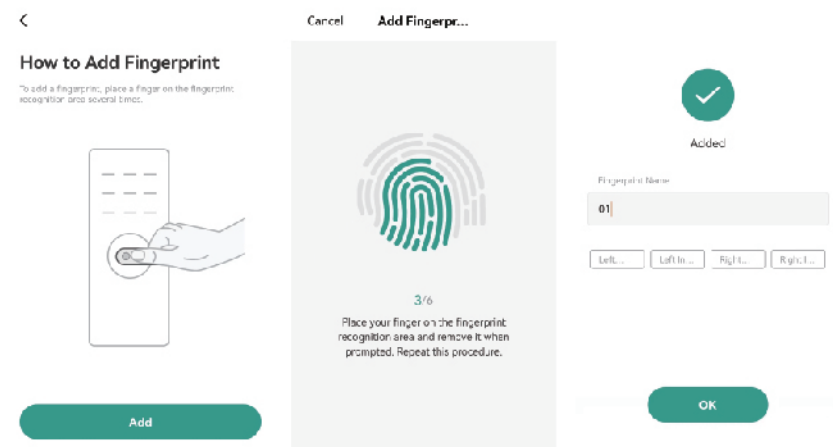

Click to start adding

Fingerprint pressed 6 times

Set the fingerprint name Click OK

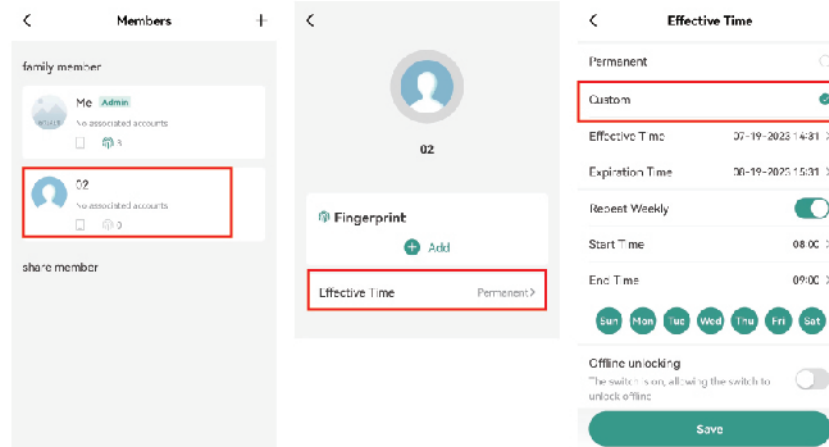

In the Member Admin Panel
Select the member

Select Effective Time

Select Custom, Set Fingerprint Permissions
Click Save

Delete Fingerprint

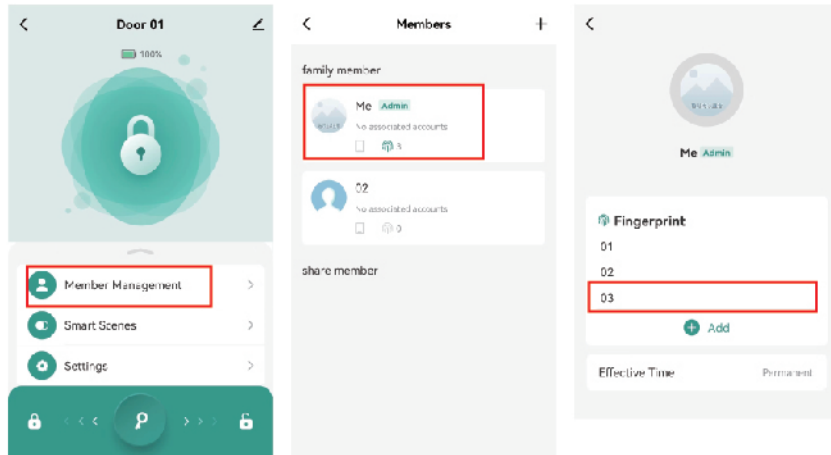

Click Member Management

Select the member to remove the fingerprint

Select the fingerprint you want to delete



Click Delete Fingerprint

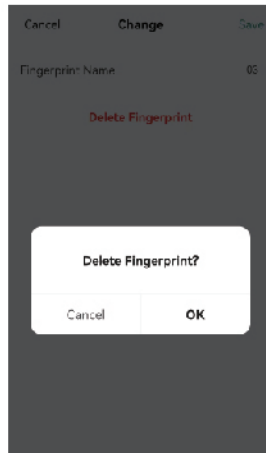

Click OK

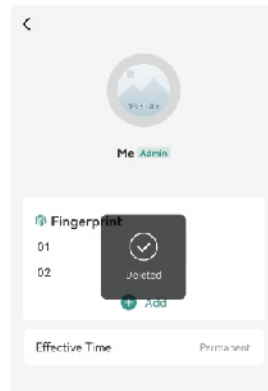

Fingerprint deleted successfully

Door lock operation record

The records of the open door log are arranged in reverse order, the unlocked ID with the user name is directly user name, and the unlocked ID is displayed.

When the door lock is connected to the Bluetooth of the mobile phone, the door record will be displayed to the APP in real time, otherwise the record will be stored locally in the door lock, waiting for the next Bluetooth connection and retransmission after opening the door.

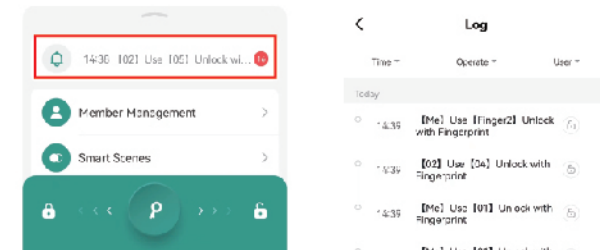

Smart Linkage Reminder

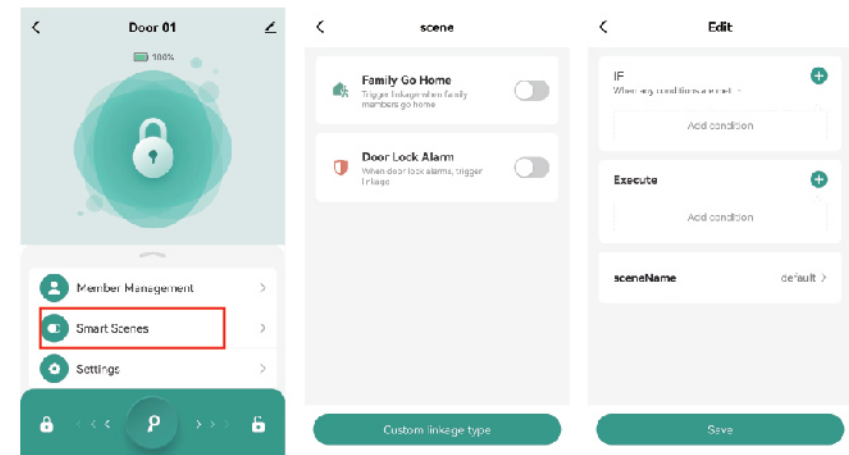

Normally Open Set / Cancel Normally

Normally Open Settings: Select the settings in the door lock interface and turn on the normally open mode.

(The door lock screen will display "Normally Open Mode is On")

Cancel Normally: Select the settings in the door lock screen to turn off the Normally mode.

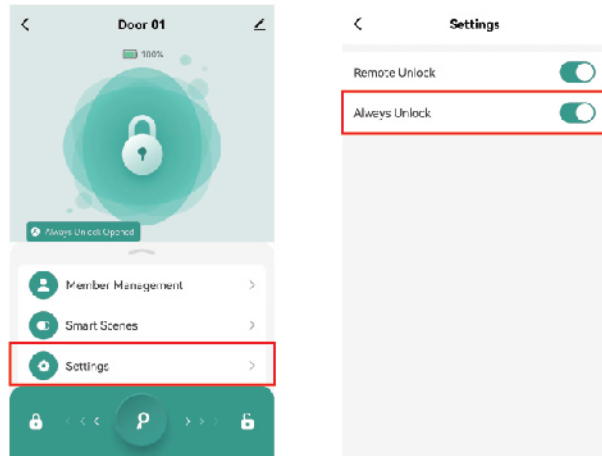

Set Normally Open mode when not connected

Long press the fingerprint head does not release for about 6 seconds, during which the motor normally unlocks the lock once, and then unlocks again to enter the normally open mode.

Cancel Normally On mode when not connected

Registered users to lay down the fingerprint, the buzzer sounds a long time, at this time the motor rotation unlocking, cancel the normally open mode.

Restore factory settings and unbind

Unbind the app side

Click "Disconnect and wipe data" to unbind the data.

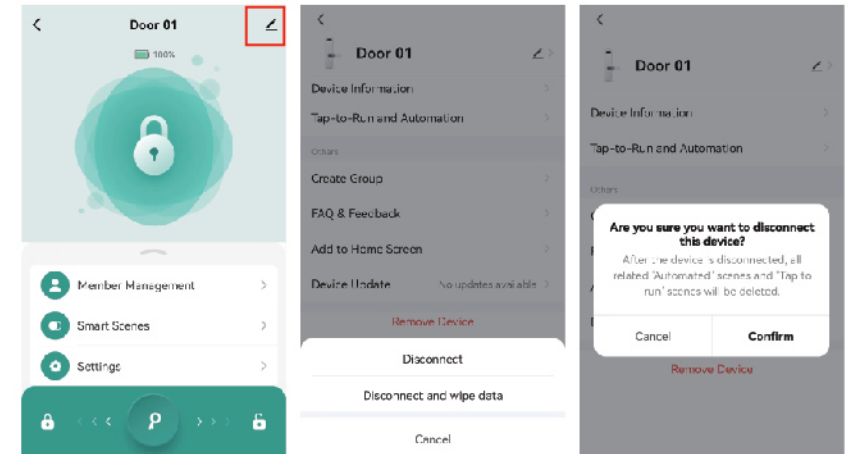

Delete user (factory reset)

Press and hold the setting button for 5 seconds until the blue indicator light is bright, the buzzer sounds 2 times, the indicator light and buzzer stop synchronously, indicating that the reset is successful.



Installation Instructions



Put the lock body into the corresponding slot and fix the upper and lower screws.



Secure the two nut posts to the front handle.

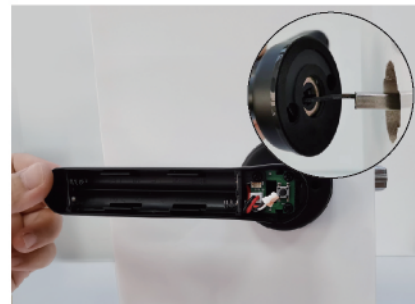

Put one end of the power cord through the center hole of the rear handle.



Align the square steel bar, tighten it with long screws, and fix the rear handle.



Put the power cord on the front handle through the square steel bar.



Note: Square steel needs to be placed at the bottom.



Plug in the power cord and install the battery.

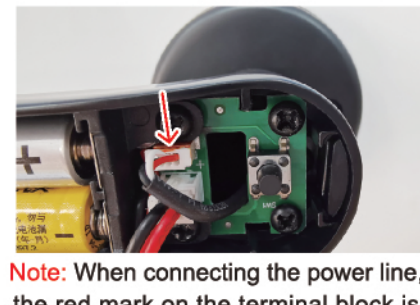

Note: When connecting the power line, the red mark on the terminal block is inserted in the same direction as the port red mark

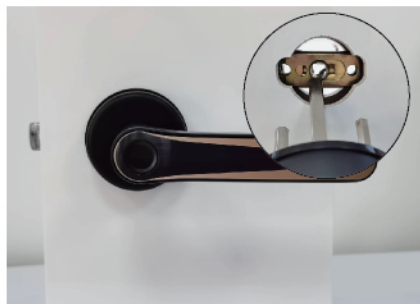

The square steel passes through the square steel hole of the lock body, secure the handle.



Loosen the screws of the rear cover plate with a hexagon wrench and remove the rear cover plate.



Fasten the rear cover plate and fix the screws of the rear cover plate.

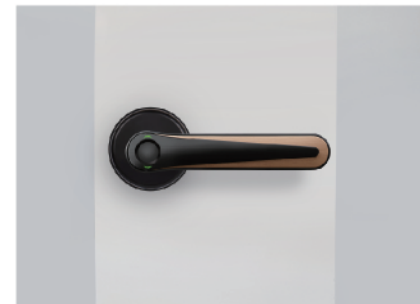

After installation, check the door opening.

Foundation Accessories

After unpacking the product, check the following accessories.

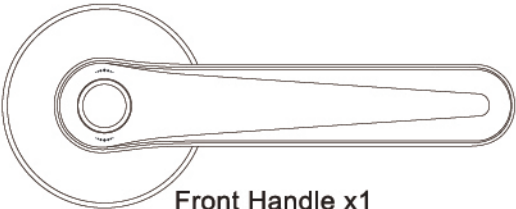

Front Handle x1



Stud X2

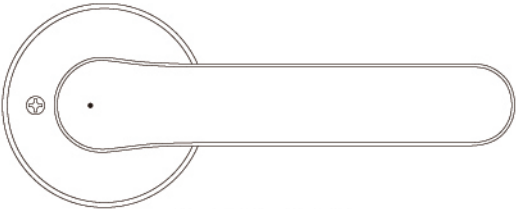

Rear Handle x1



Long Screw X2

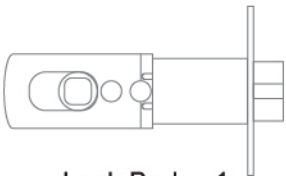

Lock Body x1



Lock Screw X2



Key X2



Latch Piece x1



Hexagon Wrench X1



Pin X1



Latch Cover X1



Hollow Square Steel X1